

Section B-B

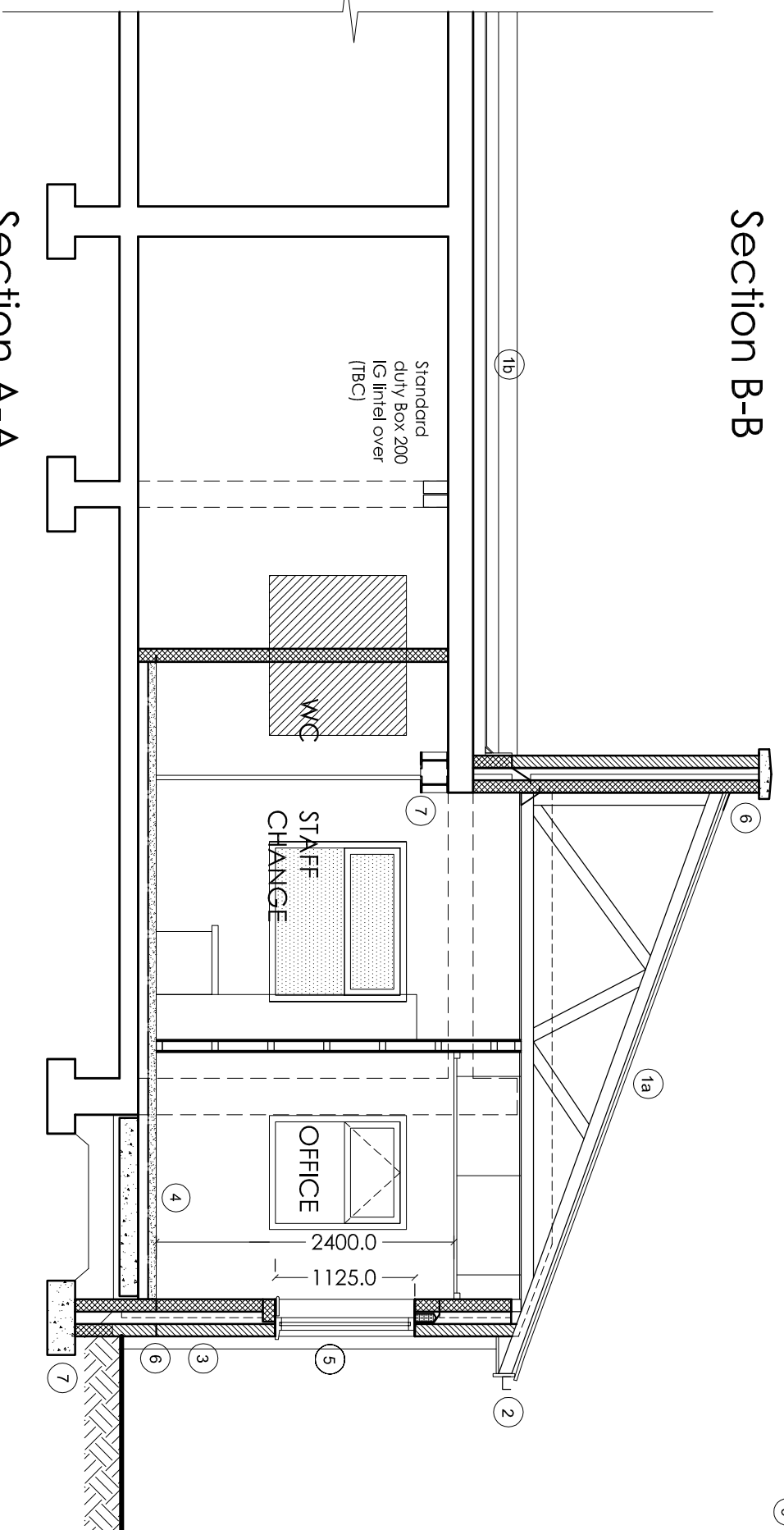

Section A-A

- 1a) **Pitched (ventilated cold) roof to achieve u-value 0.14 W/m2K:-**
Pitch 20 degrees natural slate roof:
50 x 25mm treated battens on breathable membrane to comply with BS 747 'Tyvek' or eq; Trusses to be designed by specialists @ max 600mm c/c's, lateral restraint to trusses 38 x 125mm noggins @ max 2m c/c's & 30 x 5mm galvanised MS straps across min 3 trusses back to gable walls. 3No layers 'Earthwood loft roll 44', 100mm between bottom chord of trusses 200mm above.
Foilbacked plasterboard and skim, joints taped and backed.
Suspended ceiling as indicated on section A-a/B-b/C-c
Redians' redent over fascia ventilation system to provide a min 10mm continuous ventilation at eaves
Armstrong or eq. Prima Citrus size 600 x 600 x 19mm regular, suspended lay in grid ceiling system fully clipped; prelude XL ITC24 metal grid hangers.
on existing asphalt flat roof
- 1b) **Flat (ventilated cold) roof to achieve u-value 0.14 W/m2K:-**
Xtrelva Eva polymeric membrane with integral polyester fleece backing. 2.4 mm thick mechanically fixed to insulation, laid to falls and in strict accordance with the manufacturers' recommendations on; 1000mm Kingspan 'Thermafloor TR26'; 1000 gauge polythene VCL;
on 18mm wbp plywood deck on timber firings to form fall (1:100) on 150 x 50mm C24 timber joists at 450c/c's 12.5mm foilbacked plasterboard.
- 1c) **Flat (unventilated cold) roof to achieve u-value 0.14 W/m2K:-**
Xtrelva Eva polymeric membrane with integral polyester fleece backing. 2.4 mm thick mechanically fixed to insulation, laid to falls and in strict accordance with the manufacturers' recommendations on; 1000mm Kingspan 'Thermafloor TR26'; 1000 gauge polythene VCL;
on 18mm wbp plywood deck on timber firings to form fall (1:100) on 150 x 50mm C24 timber joists at 450c/c's 12.5mm foilbacked plasterboard.
- 2) **Eaves:-**
200 x 25mm painted brch plywood fascia;
150 x 19mm WBP painted plywood soffits;
2.5mm polyester powder coated aluminium heritage section gutters to match existing;
- 3) **External walls to achieve u-value 0.27 W/m2K:-**
100mm existing/new facing brick;
100mm cavity partially filled:
50mm Kingspan 'Kooltherm K8' cavity wall board;
100mm Thermaflite Hi strength 7kN or equal concrete blockwork;
11mm Thistle hardwall undercoat;
2mm Thistle multifinish, steel trowelled;
Vertical cavities closed with cut block and damcore vertical dpc or eq. all incl vertical twist stainless steel cavity ties 225mm long at 450mm c/c's vertically, 750mm c/c's horizontally.
- 4) **Ground floor to achieve u-value 0.13 W/m2K:-**
Floor finish on Altro Mondo Evelydy A DPM on 65mm sand/cement screed on 500 gauge visqueen separating layer on 80mm Kingspan 'Thermafloor TF70' on 1200 gauge 'Isaqueen DPM continuous with DPC on 150mm RC30 concrete slab with one layer 20mm perimeter insulation on 50mm Sand Blinding.
Min 200mm level, wall blind hardware.
- 5) **Windows - UPVC framed double-glazed windows to BS 4873 to achieve 1.6 W/m2K:-**
UPVC framed windows 4mm - 20mm - 4mm.
Double glazed low - E = 0.05, argon filled, soft coat, 12mm thermal break
To include all weather strips and gaskets, trickle vents, dfl opens and restrictors where required. Fixed in accordance with manufacturers requirements. Set in bedding compound with sealer as necessary to avoid slump. Mastic gun pointing to seal perimeter.
- 6) **DPCs and flashings:-**
'Alumite' or eq dpc min 150mm above ground level.
Code 5 apron lead flashing at abutments between roofs and walls turned under new copings.
- 7) **Foundations & steelwork:-**
To structural design and calculations.
- 8) **Steps:-**
Timber steps - 2 risers, 180R 250G. Min 2m headroom.
Handrail both sides @ 1000mm high on pitch line.

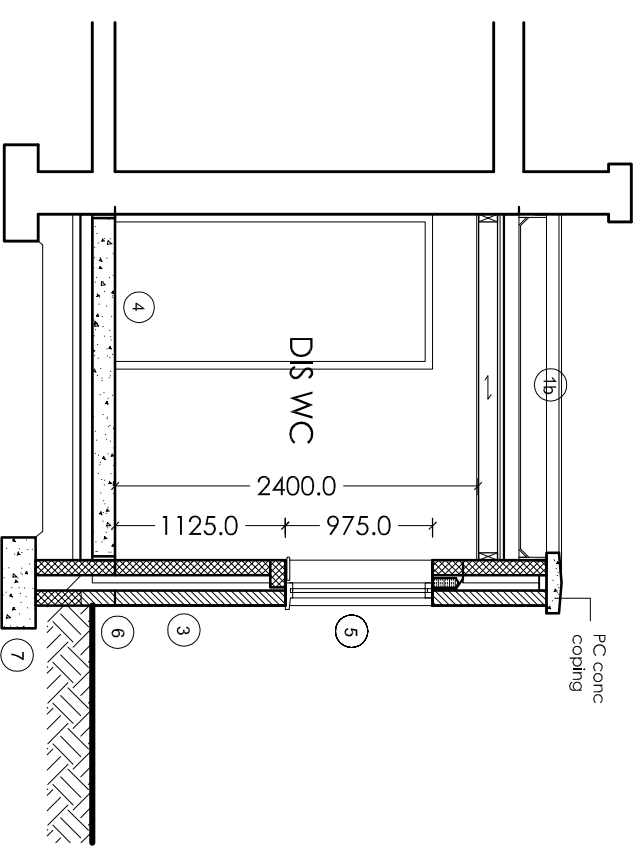

Section C-C